

# NPA

New Product Announcement

TOOLING

10-2020

APRIL 2020 • METRIC/INCH

PAGE 1 / 3



**HYDROFIT**  
HOLDING LINE

**CAMFIX**

## CAMFIX HYDROFIT Hydraulic Chuck with CAMFIX Adaptation

**HYDROFIT**  
HOLDING LINE

**CAMFIX**

## Highlights

**Following market demands, ISCAR is expanding the HYDROFIT product line by introducing new hydraulic chucks featuring CAMFIX adaptation, for all applications.**

The new HYDROFIT holders with CAMFIX adaptation have been designed for new generation compact machining centers, which combine high productivity and precision with high performance.

The CAMFIX system features high accuracy, excellent rigidity against bending forces, stability and improved torque transfer. This is achieved due to the polygonal cone face contact.

**HYDROFIT**  
HOLDING LINE

**CAMFIX**

**C#-HYDRO HD (METRIC)**

Hydraulic Chucks with CAMFIX Shanks

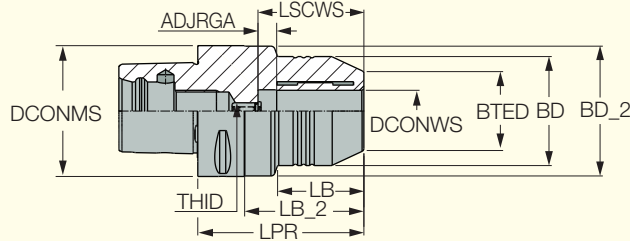
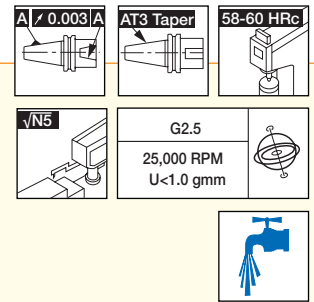

Designation	DCONMS	DCONWS	BTED	BD	BD_2	LB	LB_2	LPR	ADJRGA	LSCWS	THID	
<b>C4 HYDRO 12X65 HD</b>	40.00	12.00	32.00	-	39.50	-	44.00	65.00	10.00	46.0	M8X1	0.66
<b>C4 HYDRO 20X83 HD</b>	40.00	20.00	38.00	-	45.50	-	62.40	83.00	10.00	51.0	M8X1	0.67
<b>C5 HYDRO 12X70 HD</b>	50.00	12.00	32.00	42.00	49.50	33.00	50.00	70.00	10.00	46.0	M8X1	1.44
<b>C5 HYDRO 20X75 HD</b>	50.00	20.00	38.00	-	49.50	-	54.00	75.00	10.00	51.0	M8X1	1.44
<b>C6 HYDRO 12X75 HD</b>	63.00	12.00	32.00	42.00	62.50	33.00	53.00	75.00	10.00	51.0	M8X1	1.44
<b>C6 HYDRO 20X80 HD</b>	63.00	20.00	38.00	53.00	62.50	41.00	57.40	80.00	10.00	51.0	M8X1	1.59
<b>C6 HYDRO 20X120 HD</b>	63.00	20.00	38.00	52.50	62.50	41.00	97.40	120.00	10.00	51.0	M8X1	2.51
<b>C6 HYDRO 32X90 HD</b>	63.00	32.00	58.50	-	62.50	-	67.00	90.00	10.00	61.0	M8X1	1.94

**C#-HYDRO HD (INCH)**

Hydraulic Chucks with CAMFIX Shanks

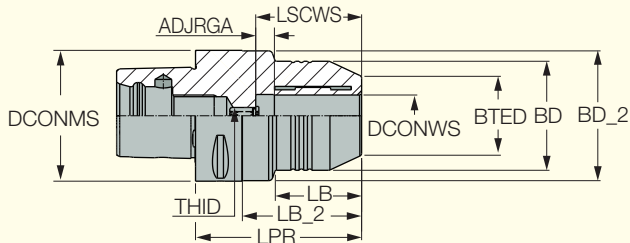
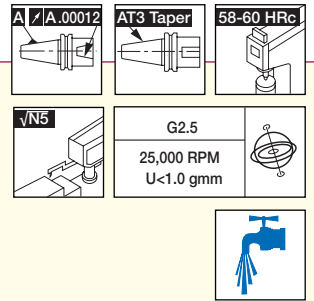

Designation	SS	DCONWS	BTED	BD	BD_2	LB	LB_2	LPR	ADJRGA	LSCWS	THID	
<b>C4 HYDRO 1/2X2.56 HD</b>	40	12.700	1.259	-	1.5550	-	1.732	2.559	.393	1.811	M8X1	1.45
<b>C4 HYDRO 3/4X3.268 HD</b>	40	19.050	1.535	-	1.7910	-	2.456	3.267	.393	2.007	M8X1	1.47
<b>C5 HYDRO 1/2X2.756 HD</b>	50	12.700	1.299	1.6530	1.9480	1.259	2.086	2.755	.393	1.811	M8X1	3.18
<b>C5 HYDRO 3/4X2.953 HD</b>	50	19.050	1.496	-	1.9480	-	2.125	2.952	.393	2.007	M8X1	3.18
<b>C6 HYDRO 3/4X3.15 HD</b>	60	19.050	1.496	2.0660	2.4600	1.614	2.259	3.149	.393	2.007	M8X1	3.50
<b>C6 HYDRO 1-1/4X3.543 HD</b>	60	31.750	2.303	-	2.4600	-	2.637	3.543	.393	2.007	M8X1	4.28