

Adapter Assembly on CAMFIX Shanks

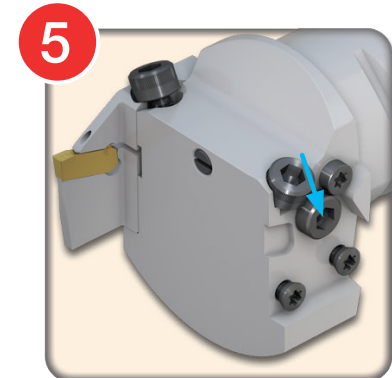
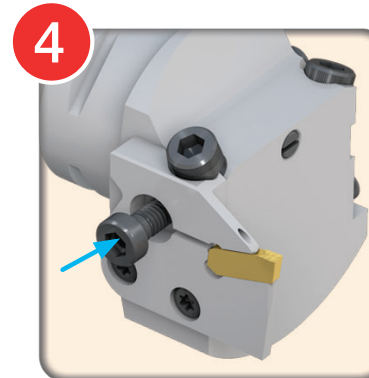
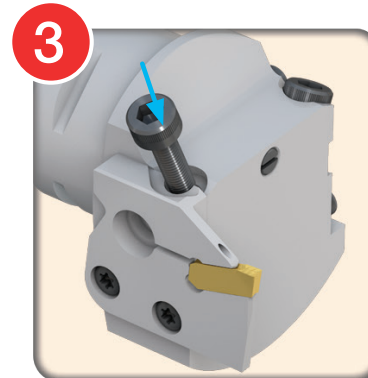
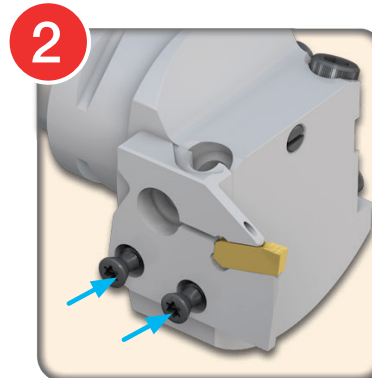
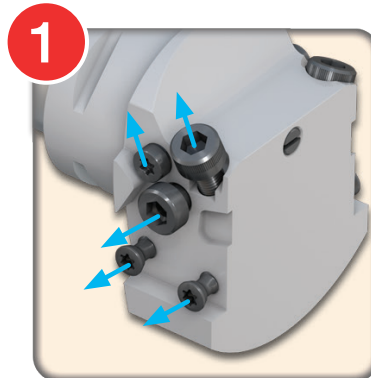

The tool is supplied with a long upper clamping screw which is inserted diagonally, two short bottom clamping screws, two middle (securing/sealing) screws and four sealing O-rings (two are spare).

- Unscrew all five screws and check that the O-rings are in place **(1)**
- Start by clamping the adapter with the two short bottom screws **(2)**

- Place the insert into the pocket and clamp the long diagonal screw **(3)**
- Tighten the middle (securing) screw **(4)**
- Finally, seal the opposite threaded hole with the sealing screw **(5)**

Note: The only purpose of the middle screw (SR M6X12DIN6912) is to secure the adapter against the O-ring and holder, in order to ensure a seal.